

(4 1 - 1) MCON board setting

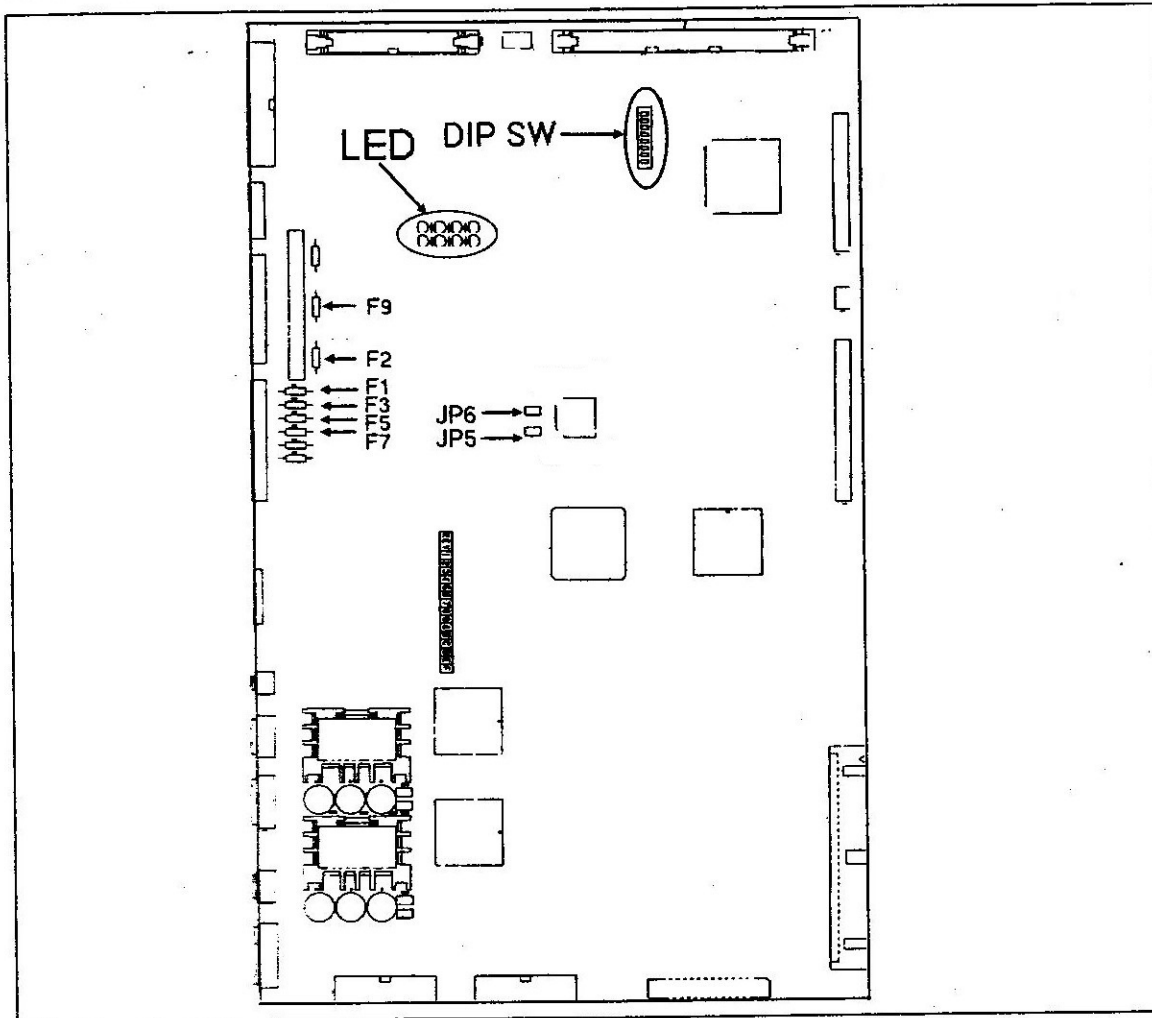

[List of fuses]

Fuse No.	Electric current value [A]	Model No.	PART CODE	Rating	Related motor
F1	0.5			1/2A	ND changer motor
F2	0.75			3/4A	Tail punch motor
F3	0.375			3/8A	Front slack guide motor
F5	0.375			3/8A	Rear slack guide motor
F7	0.375			3/8A	AT guide motor
F9	0.75			3/4A	Head punch motor
F12	0.5			1/2A	Cutter motor

※ All fuses are made by Ritel.

【DIP SW settings】

DIPSW No.	Description
1	Sets forced start-up mode when this switch is turned ON.
2	Unused.
3	Sets negative image output when this switch is turned ON. (only in REMOTE mode.)
4	Set mirror image output when this switch is turned ON. (only in REMOTE mode.)
5	Ignores the reset of the calendar-IC when this switch is turned ON. The Adjust DATE TIME error is not issued.
6	Executes operation without serial communication with the processor, when this switch is turned ON. Therefore, the operation including discharging is not performed.
7	Executes operation without communication with the SCOM board, when this switch is turned ON. Therefore, the operation in REMOTE mode cannot be performed.
8	When this switch is turned ON, distortion adjustment is not performed.

Normal setting : all "OFF"

【Table of jumper settings】

Jumper	Description
J P 5	Shorted : Activates the Flash ROM. Open : Deactivates the Flash ROM.
J P 6	Shorted : Enables writing to the FPGA on the board. Open : Disables writing to the FPGA on the board.

Normal setting : All "Shorted"

【Table of LED functions】

All are unused.